

DRAWING IS PRODUCED USING THE IRISH TRANSVERSE MERCATOR (ITM) GEOGRAPHIC COORDINATE SYSTEM

**A1**

**LEGEND:**

- LANDS IN THE OWNERSHIP OF THE APPLICANT/ LANDOWNER
- PROPOSED SID APPLICATION SITE BOUNDARY
- PROPOSED COMPOUND FENCE
- PROPOSED ASPHALT ROAD
- PROPOSED STONED AREA
- PROPOSED CONCRETE FOOTPATH
- PROPOSED CONCRETE SLAB
- PROPOSED ASPHALT SURFACE
- PROPOSED MAINTENANCE GRAVEL ROAD
- PROPOSED LANDSCAPING
- PROPOSED UNIT SUB
- PROPOSED MARSHALLING KIOSK
- PROPOSED SURFACE WATER
- PROPOSED SURFACE WATER MANHOLE
- PROPOSED GULLY CONNECTION
- PROPOSED MASTS
- PERMITTED 2.4m PALISADE SECURITY FENCE
- PERMITTED SURFACE WATER NETWORK
- PERMITTED SURFACE WATER CHAMBER
- PERMITTED ASPHALT ROAD
- PERMITTED EMBANKMENT AREA
- PERMITTED CONCRETE FOOTPATH

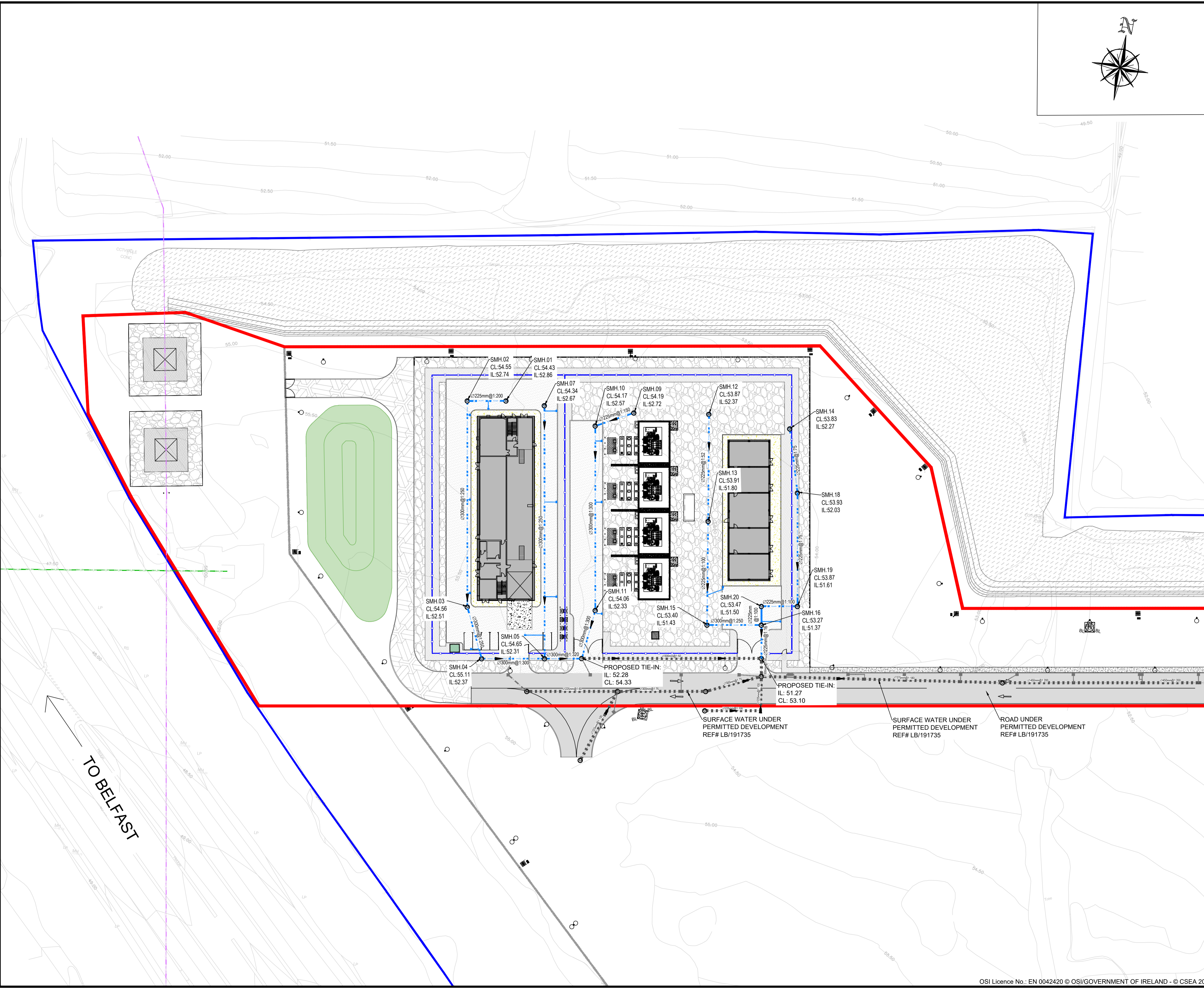

Rev	Description	Drawn	Checked	Date
P05	SID ISSUE	DM	PM	05.11.2020
P04	SID ISSUE	DM	PM	03.11.2020
P03	EIRGRID REVIEW	DM	PM	13.10.2020
P02	DP01 ISSUE	DM	PM	10.09.2020
P01	FOR DISCUSSION	DM	PM	28.08.2020

**Clifton Scannell Emerson Associates**

Clifton Scannell Emerson Associates Limited  
Consulting Engineers,  
Seaforth Lodge,  
Castledawson Avenue,  
Blackrock, Co. Dublin,  
Ireland, A94 P768

T: +353 1 288 5006  
F: +353 1 283 3466  
E: info@csea.ie  
W: www.csea.ie

<b>CAP DEVELOPMENTS LLC</b>	
Client	
<b>OLDBRIDGE 110KV SUBSTATION</b>	
Project	
<b>PROPOSED &amp; EXISTING SURFACE WATER DRAINAGE LAYOUT</b>	
Dwg. Title	
Drawn By	DM
Date	OCTOBER 2020
Checked By	LM
Scale	1:500 @ A1
CSEA Job No.	20_057
Project Code	
Originator	
Zone/Phase	
Level	
Type	
Role	
Dwg. No.	
<b>CAP - CSE - 00 - XX - DR - C - 2110</b>	
S2	SUITABLE FOR INFORMATION
Status Code	Suitability Description
P05	PLANNING
Revision	Project Status